



SAN DIEGO COMMUNITY COLLEGE DISTRICT

City College • Mesa College
Miramar College • Continuing Education



MEDIA ADVISORY

February 16, 2011

Media Contact:
Sandra Trevisan
Public Information Officer
San Diego Miramar College
(619) 388-7752
strevisa@sdccd.edu

Media Contact:
Ursula Kroemer
Communications Director
Propositions S & N
(cell) (760) 705-6919
ukroemer@gafcon.com

New Humanities & Arts and Mathematics & Business Buildings open at San Diego Miramar College

*State-of-the-art buildings are on track to obtain LEED Gold certification for "green" building;
First Propositions S & N projects to be fully integrated in 3-D building information modeling*

What: San Diego Miramar College will celebrate the formal grand opening of its [Humanities & Arts Building](#) and [Math & Business Building](#), along with a new campus center to be called the Compass Center. The two buildings, previously honored as [Projects of Distinction winners](#) in the 2008 Education Design Showcase, are on track to obtain a Leadership in Energy and Environmental Design (LEED) Gold certification by the United States Green Building Council (USGBC).

The Humanities & Arts Building consists of approximately 45,000 gross square feet of new construction to house the English, Visual Arts, Music, Speech and Foreign Language programs. The building includes "smart" classrooms, a lecture hall, recording studio, studio space for drawing, painting and ceramics, and related office space for faculty and support staff.



The Math & Business Building consists of approximately 45,899 gross square feet that includes new "smart" classrooms equipped with computers, audiovisual and multimedia equipment, a mathematics research center and related office space for faculty and support staff.

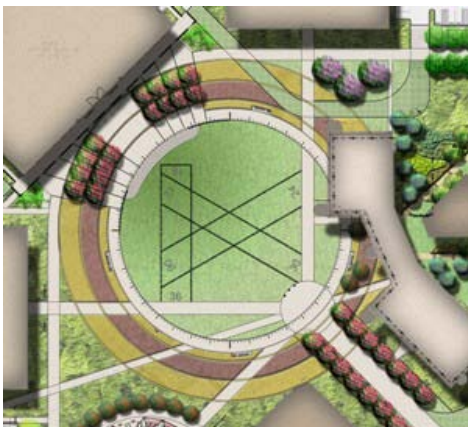

The ceremony will also include the formal opening of the new Compass Center, a giant circular azimuth compass feature in what will be the new central gathering point on campus. The design recognizes and celebrates the important history of aviation at the Miramar campus, a former military airfield site known as the Hourglass Field. Flagstone runways are set within the compass shaped in the form of the original Hourglass Field, while the compass feature

creates spacious pedestrian pathways that connect the surround buildings, both new and existing.

The \$34.4 million dual-classroom building project was funded as part of the San Diego Community College District's \$1.555 billion [Propositions S and N construction bond program](#). The projects were the first to be fully integrated in [Building Information Modeling](#) (BIM), a cutting-edge development in the architecture, engineering and construction industries that allow the team to create a building in digital space before building it in real space.



When: Tuesday, February 22, 1:00 p.m.

Where: San Diego Miramar College

Who: (order of speakers)

Darrel Harrison, Past President, Academic Senate (Host/Emcee)

Patricia Hsieh, Ed.D., President, San Diego Miramar College

Rich Grosch, President, Board of Trustees, SDCCD

Constance M. Carroll, Ph.D., Chancellor, SDCCD

David Umstot, Vice Chancellor, Facilities Management, SDCCD

Lou Ascione, Dean, School of Liberal Arts, San Diego Miramar College

Paulette Hopkins, Dean, School of Business, Math, Science, San Diego Miramar College

Daphne Figueroa, President, Academic Senate, San Diego Miramar College

Franchesca Gade, President, Associated Student Council

Visuals

- Official ribbon-cutting with giant scissors. Sixty students, faculty and staff will form a human chain holding a length of ribbon that connects the two new buildings with the Compass Center
- Full-color architectural renderings
- Tours of the facility

Sustainable Features:

As part of the San Diego Community College District's Green Building Policy, all construction and major renovations under Propositions S and N are designed and built to obtain the highest possible certification from the U.S. Green Building Council's Leadership in Energy and Environmental Design (LEED) program. The Humanities & Arts and Math & Business Buildings are tracking LEED Gold certifications and include a number of sustainable features:

- Sloped roofs provide north-facing clerestory windows (a band of narrow windows along the very top of a high wall, allowing light to filter into adjacent spaces) and south-facing photovoltaic panels.
- The design includes efficient thermal "massing," which delays the transfer of heat throughout the course of a day, and minimizes the impact of a heating or cooling load on a building. Heavy materials such as concrete, brick and stone can all be used to achieve thermal massing.

- All windows utilize 'high performance' glass that allows sunlight to filter into the building, but reduces the amount of UV light and solar heat entering the building.
- Recycled materials, high efficiency lighting, plumbing and mechanical systems are used throughout the project.

Project Partners:

- **Architect:** NTD Architecture
- **Construction Manager:** Sundt Construction (CMMP project)
- **Structural Engineer:** Wiseman + Rohy Structural Engineers
- **Electrical Engineer:** Michael Wall Engineering
- **Mechanical Engineer:** DCE, Inc.
- **Compass Center Designer and Landscape Architect:** Wimmer Yamada & Caughey
- **Propositions S & N Program Manager:** Gafcon, Inc.
- **Campus Project Manager:** James Bray, Gafcon, Inc.

To obtain high-resolution renderings and/or construction photographs, please contact Ursula Kroemer at (760) 705-6919 or ukroemer@gafcon.com.

The projects were funded by the San Diego Community College District's \$1.555 billion Propositions S and N construction bond program, which is providing for new instructional and career training facilities, major renovations, parking and public safety enhancements, and campus wide infrastructure projects at City, Mesa and Miramar Colleges, along with six Continuing Education campuses. To learn more, visit www.public.sdccdprops-n.com

#####