



## PROPOSITIONS S & N FACILITIES UPDATE – August 2010

### Welcome back to campus!

To keep our City College community updated on campus construction, below you'll find a status report on all current projects. The new Career Technology Center is open, and we begin preliminary construction activities for the new Arts & Humanities and Business Technology buildings. The expansion of the new Central Plant is close behind. We appreciate your continued patience with these construction activities as we continue with the dramatic physical transformation of the campus. Thanks especially to the dedicated faculty and staff participating in the defining of interior space requirements and selection of interior finishes and furniture, fixtures and equipment (FF&E).

*David Umstot, PE, Vice Chancellor, Facilities Management*

### Career Technology Center (CTC)

The Career Technology Center (CTC) is now open and home to the Nursing, Cosmetology, and Photography and Digital Arts programs. The project includes a multi-level parking structure (with the nation's largest vertical solar array). There have been some questions about the height clearance in the structure, and I want to provide the facts. There were some quality control issues involving vertical clearance in the structure, bringing those clearances below current code requirements of 7'0". None of these issues pose any safety or structural issues. These issues have all been addressed and resolved, and the resolutions met with the approval of the Division of the State Architect (DSA), our permitting authority. We have installed specific signage and striping to address the reduced height clearances. The state inspector has approved the elevator and the structure will open for use on August 23<sup>rd</sup>.



### Arts & Humanities/Business Technology Buildings

Preliminary construction activities will begin this month for the Arts & Humanities and Business Technology buildings.



Our contractors will be breaking up and removing concrete near the Saville Theater, and there will be some selective demolition of the old "S" Building to the north of the theater. Some trees will be removed as well. These will be mulched and the mulch distributed to grounds crews throughout the District. Construction of the actual classroom building is not expected to begin until later this fall after the balance of the project construction documents have been approved by the DSA. User meetings continue for the review and selection of interior finishes and FF&E. If you'd like to see different views of the

project, please visit [http://public.sdccdprops-n.com/Projects/City/1111\\_Docs/2009-1109\\_BHQ-COC.pdf](http://public.sdccdprops-n.com/Projects/City/1111_Docs/2009-1109_BHQ-COC.pdf)



## Math & Social Sciences

This 72,000 sq. ft. classroom building, west of the CTC, will have four floors of academic classrooms and laboratories. The project is in review by the DSA and the expected 'stamp out' date is in October. The design team continues to meet with the users to Identify final interior finishes and to continue with FF&E planning. project includes the relocation of a small Victorian home on the property. This step requires approval by the City. Officials are currently reviewing the necessary documents. To view other renderings and see photos of the architectural model for the project, please visit the Propositions S and N website at: <http://public.sdccdprops-n.com/Projects/City/Pages/1181.aspx>.



Learning Resource Center

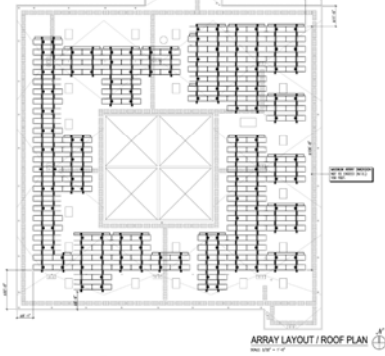

## Photovoltaic (Solar) Arrays

Installation of our new solar arrays will occur this fall. The system planned for the LRC will produce in excess of 140,000 kWh of green energy annually. The array for the Harry West Gym will produce close to 250,000 kWh. Combined, this is the equivalent of removing 56 cars off the roads annually.

Harry West Gym

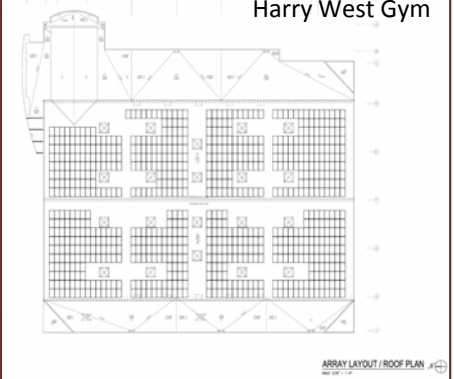

## Infrastructure



As part of the Central Plant project, the existing cooling tower will be relocated to its new temporary home. Starting August 26th, the tower will be isolated, all related mechanical and electrical systems shut down, and the tower drained of water. Once placed in its new location, all pumps, piping and chemical filtration will be reinstalled. This will involve shutting down chilled water for approximately four days. District maintenance staff are looking at ways to minimize the inconvenience to the campus. The underground distribution piping element of this project will affect access through Gorton Plaza for three more weeks. The section which is just being backfilled in front of the M Building will be completed by the end of this week. The section in front of the D Building will take another three weeks.

## City College Campus Project Management Team

**Campus Project Manager**  
Thomas J. Fine, CCM  
619.388.3096  
[tfine@sdccd.edu](mailto:tfine@sdccd.edu)

**Project Manager**  
Guy Meades  
619. 388-3101  
[gmeades@sdccd.edu](mailto:gmeades@sdccd.edu)

**Assistant Project Manager**  
Rachel Fornaca  
619.388.3103  
[rfornaca@sdccd.edu](mailto:rfornaca@sdccd.edu)

**Assistant Project Manager**  
Paul Wraa  
(619) 388-3189  
[pwraa@sdccd.edu](mailto:pwraa@sdccd.edu)