



San Diego Community College District

PROPOSITIONS S & N PROJECT FACT SHEET

Student Services Center

Campus	San Diego Mesa College
Address	7250 Mesa College Drive San Diego, CA 92111-4998 619.388.2604 www.sdmesa.edu
Architect	ARCHITECTS hanna gabriel wells
Construction Manager	PCL Construction

<http://www.public.sdccprops-n.com/Mesa-College/Projects/1241.aspx>



Project Description

The new four-story, 85,000 gross square foot building will include new facilities for student services on campus. Services include Admissions, Financial Aid, Evaluations and Testing, Counseling, Student Government, Disabled Student Services, Information and Outreach, classrooms, conference areas and a Terrace Café. The project also includes a new express elevator between the lower parking lot and the upper campus. The facility is designed to obtain a Leadership in Energy and Environmental Design (LEED) Silver certification by the United States Green Building Council (USGBC).



View of indoor lobby

Special Features

All of the departments are arranged around an open four-level atrium, where students can interact with each other and the various departments in a single location. Each department opens into the atrium without doors, encouraging students and department faculty to engage each other without barriers.

Each floor opens up onto a series of outdoor terraces that move up the hillside from the lower parking lot to the upper campus. A grand stair connects the upper and lower plazas to form a bold new campus entryway.

The colors of the building relate to the colors and textures of the trees that cover the hillside slopes adjacent to the project, connecting the building to its location on campus and creating a vibrant point at the new north entryway to the campus.

The building is designed to meet LEED Silver certification. Projected energy savings of 340,000 kWh annually are 38% better than state requirements. Water-efficient plumbing, irrigation and landscape will result in a water savings of 40% on the building use and 50% on landscape. The project will include materials and finishes that include recycled content, attention to Indoor air quality and the use of natural daylight.



View from lower plaza



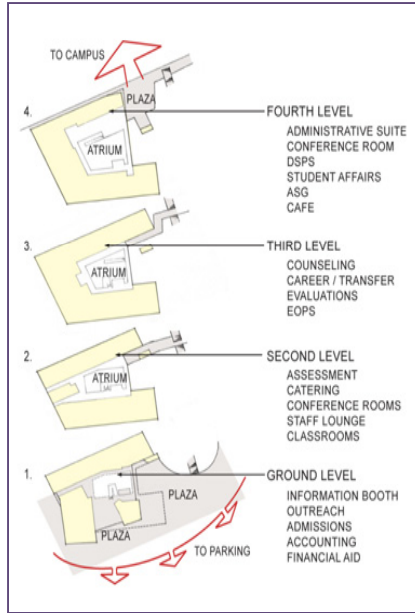
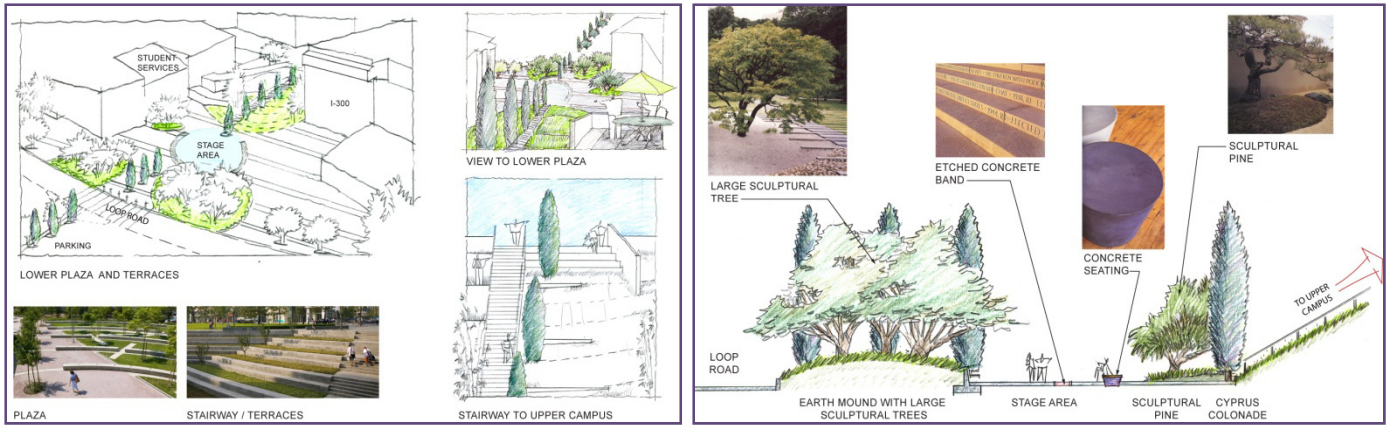

Chinese Flame Tree



Indian Hawthorn



Mexican Feather Grass



Italian Cypress

Fast Facts

Project Name	Student Services Center
Funding Source	Proposition S
Architect	ARCHITECTS hanna gabriel wells
Construction Manager	PCL Construction
Propositions S and N Program Manager	Gafcon, Inc.
Civil Engineer	Snipes-Dye Engineering
Electrical Engineer	Michael Wall Engineers
Mechanical Engineer	McParlane and Associates
Landscape Architect	MLA Design Studio
Campus Project Manager	Diane Malone, Gafcon, Inc.
Construction Start Date	Spring 2010
Project Budget	\$46.8 million
Targeted Completion Date	Spring 2012